

VISION³

LIGHTING

Electronic Transformer **MODEL XM3** 120/230/277 VAC, 60/75/80/150W Electronic Transformers

Specifications:

60 & 80W versions:

- Electronic circuitry epoxy sealed in an aluminum enclosure.
- Input: 60W - 120 VAC, 50/60 Hz.
80W - 120 or 277 VAC, 50/60 Hz.
- Output: 11.5 VAC
- Power factor: 60W > .90.
80W > .95.
- Ambient temperature range: -20°C to 50°C.
- Max. case temperature: 85°C.
- Minimum load: 60W - No minimum load.
80W - 5W minimum.
- Dimmable (120V version only).
- Soft start circuitry.
- Electronic short-circuit and overload protection.
- UL tested & certified to US and Canadian safety standards.

75W version:

- Electronic circuitry encapsulated in a flame retardant plastic casing.
- 120, 230, or 277 VAC, 50/60 Hz input.
- 11.6 VAC output.
- Power factor > .93.
- THD < 20%.
- Operating frequency > 20 kHz.
- Class A insulation system.
- Operating temperature range of -15°C to 90°C.
- Minimum load of 10 Watts.
- Dimmable (120V version only). Minimum load of 40 Watts for proper functioning.
- For non short proof units, do not short output conductors.
- CSA & UL tested & certified to US and Canadian safety standards.

150W version:

- Electronic circuitry encapsulated in a flame retardant plastic casing.
- 120 or 277 VAC, 50/60 Hz input.
- 11.6 VAC output.
- Power factor > .93.
- THD < 20%.
- Operating frequency > 20 kHz.
- Class A insulation system.
- Operating temperature range of -15°C to 90°C.
- Minimum load of 10 Watts.
- Dimmable (120V version only). Minimum load of 40 Watts for proper functioning.
- For non short proof units, do not short output conductors.
- CSA & UL tested & certified to US and Canadian safety standards.

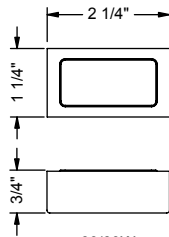
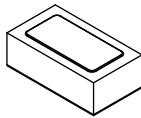

60/80W

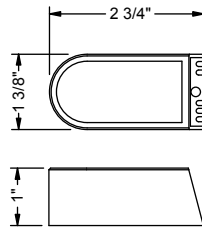
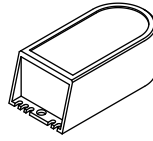

75W

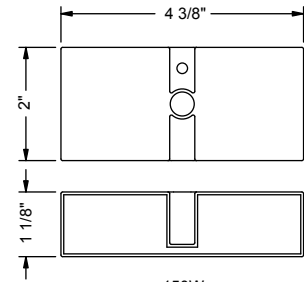
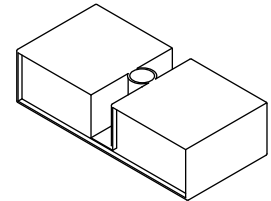

150W



Ordering Information:

XM3		
Model	Wattage	Voltage
XM3 - Electronic Transformer	60 - 60W ^{1,2,3}	120 - 120 Volts
	75 - 75W	120ND - 120 Volts, Non Dimmable ¹
	80 - 80W ^{1,2}	230 - 230 Volts ²
	150 - 150W ^{1,2}	277 - 277 Volts ³

Electronic Transformer Compatibility Tips*

	120V	230V	277V
Halogen Lamp:	XM3-75-120 XM3-80-120 XM3-150-120	XM3-75-230	XM3-75-277 XM3-150-277
Retrofit LED 'drop in' Lamp:	Consult manufacturer of drop in LED for their recommendations.		
Vision3 4W LED Module:	XM3-60-120	Contact Vision3.	Contact Vision3.
Vision3 10W LED Module:	XM3-60-120	Contact Vision3.	Contact Vision3.
Vision3 12.5W LED Module:	XM3-60-120	Contact Vision3.	Contact Vision3.

* - Non-dimmed systems only. For systems using dimmers, contact Vision3 lighting.

Notes:

- '120ND' Voltage option is not available with '60', '80', or '150' Wattage options.
- '230' Voltage option is not available with '60', '80', or '150' Wattage options.
- '277' Voltage option is not available with '60' Wattage option.
- Specifications, certifications, and ordering information are subject to change. Please check website for latest specification sheets.

Example: XM3 - 75 - 277