

Installation Instructions

INSTRUCTIONS PERTAINING TO A RISK OF FIRE, OR INJURY TO PERSONS.

IMPORTANT SAFETY INSTRUCTIONS. SAVE THESE INSTRUCTIONS.

(Failure to follow the warnings and instructions on this sheet could result in fire, injury, failure of product, and/or voiding of warranty.)

1. Do not touch while lamp is on. Turn off/unplug and allow to cool before replacing lamp.
2. Lamp gets HOT quickly! Contact only switch/plug when turning on.
3. Do not touch hot lens, body, cap or knuckle.
4. Keep lamp away from materials that may burn.
5. Do not touch lamp at any time. Use a soft cloth. Oil from your skin may damage lamp.
6. Do not operate with damaged or missing parts.
7. Do not disassemble beyond cap removal to facilitate lamp and/or accessory installation or replacement.
8. Remove any debris accumulated in the cap periodically.
9. Do not install within 10 feet of a pool, spa, or fountain.
10. Have installed in accordance with all applicable installation codes and standards by a person familiar with the construction, operation, and hazards involved.
11. Consult a qualified electrician to ensure correct branch circuit conductor.
12. Use only cable rated for low voltage. Cable buried more than 6" must be suitable for direct burial. Direct burial cable may be ordered from Vision3 Lighting.

Installation:

Install fixture by threading the knuckle into the mount hole of an appropriate mount option. Use supplied O-ring (when used on compatible mount) for water tight installation. Use supplied Lock Nut to secure fixture to mount option. See mount option installation instructions for further installation procedures.

Notes:

- This fixture should not be mounted in such a way that it is buried or in direct contact with the ground or soil.
- This fixture requires a remote transformer or mount option with integral transformer.
- LED models should only be powered and controlled by compatible transformers and control systems. Contact Vision3 Lighting for approved transformer / controls list. Using non-approved transformers / controls could cause the LED to not operate properly or fail.
- Integral LED options can require up to 13W (10W options) or 15W (12.5W options) during startup, under some circumstances. This must be allowed for when designing system.
- Integral LED options come with a High/Low switch. See 'LED Switching' instructions on next page. Switch will be set to 'High' setting at the factory, unless otherwise specified when ordered.
- LED ratings subject to change without notice. See website or contact V3 for most current info.

Caution! Fixture will be hot if lamp is on. Remove power and allow fixture to cool before performing any adjustments or maintenance.

Fixture Aiming:

1. Loosen the Vertical Adjustment Screw using a 3/16" hex tool – do not loosen screw more than 1/2 turn!
2. Grab fixture Body and push/pull to break grip of tapered knuckle lock.
3. Slightly tighten Vertical Adjustment Screw, using the 3/16" hex tool, so that fixture holds position when released, but still moves when adjusted.
4. Slightly loosen the Horizontal Adjustment Screw using the 3/16" hex tool - do not loosen screw more than 1 full turn!
5. Grab fixture Body and gently rotate to break grip of tapered clamp lock.
6. Slightly tighten the Horizontal Adjustment Screw so that the fixture can be rotated, but still holds position.
7. Adjust fixture to the desired angle. Do not force the fixture past the natural stops built in to the knuckle. Rotate fixture fully in opposite direction if a stop is hit before reaching the desired position.
8. Tighten the adjustment screws using the 3/16" hex tool. Do not over tighten! Tapered knuckle lock requires very little tightening to ensure fixture is locked in position.

Lamp/LED Module Maintenance:

1. Remove power from fixture and let cool before touching. **Caution! Fixture may still be hot!**
2. Loosen the four Captive Cap Screws using a 5/32" hex tool – do not remove screws from cap!
3. Remove the Cap. Note: A small non-marring flat bladed screwdriver may be used to pry off Cap.

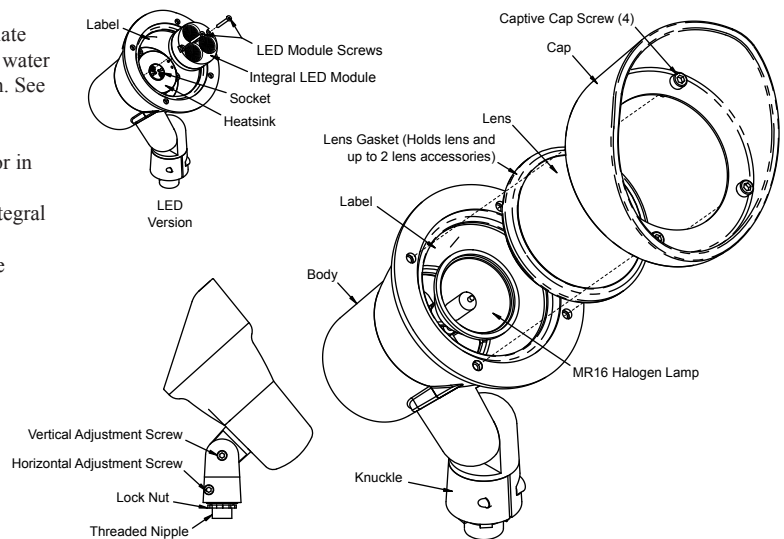

4. Pull Lens Gasket, Lens, and Accessories (if any) out of Body. A small flat bladed screwdriver may be used to pry the Lens Gasket away from the Body. Lens Gasket is soft, be very careful not to cut or rip.
5. Inspect the Lens Gasket for damage. Replace if necessary.
6. Replace lamp/LED.

For MR16 Halogen Lamp:

- a. Pull lamp straight out. **Caution! Lamp may still be hot! Be sure lamp has cooled before touching.**
- b. Inspect socket for any damage.
- c. Clean inside of fixture and Cap with a clean dry cloth.
- d. Push new lamp straight in, being careful to align pins. **Note:** Replacement lamp must not exceed ratings on Label.

For LED Module:

- a. Loosen and remove the LED Module Screws using a 1/16" hex tool.
 - b. Pull LED straight out. Do not twist or the pins will break off in the socket. **Caution! LED may still be hot! Be sure LED has cooled before touching.**
 - c. Clean the grease off of the Heatsink top surface using a rag dipped in alcohol.
 - d. Inspect the socket for any damage.
 - e. If the replacement LED Module does not come with a thermal transfer pad on the base, apply a thin layer of thermal grease (not supplied) to the surface of the Heatsink that will contact the bottom of the LED Module.
 - f. Align the pins on the LED Module with the socket and push straight in. Do not twist or push in at an angle or the pins may be damaged.
 - g. Install and tighten the LED Module Screws. **Caution!** Over tightening of screws could crack the LED Module case.
7. Clean sealing surfaces on Body and Cap with a clean, damp cotton cloth

Installation Instructions

INSTRUCTIONS PERTAINING TO A RISK OF FIRE, OR INJURY TO PERSONS.

IMPORTANT SAFETY INSTRUCTIONS. SAVE THESE INSTRUCTIONS.

(Failure to follow the warnings and instructions on this sheet could result in fire, injury, failure of product, and/or voiding of warranty.)

8. Set Lens Gasket (with Lens and Accessories in it) into the Body, with the Lens facing out.
9. Set the Cap on top of the Lens Gasket, with the Captive Cap Screws aligned to the threaded holes in the Body.
10. Tighten the four Captive Cap Screws with the 5/32" hex tool in a criss-cross pattern until the Cap is fully seated on the body. **Do not over tighten the Captive Cap Screws!**

LED Switching (on certain models):

1. Remove cap as explained in Lamp Maintenance steps 1 thru 5.
2. Inspect for damage. Replace any damaged parts, if necessary.
3. Clean inside of fixture and Cap with a clean, damp cotton cloth.
4. Find LED High/Low Switch on side of Integral LED Module.
5. Using a pin, small nail, etc, flip the switch in the desired direction. See the LED Module Switch sketch for which direction corresponds to which setting.
6. Install cap as explained in Lamp Maintenance steps 7 thru 10.

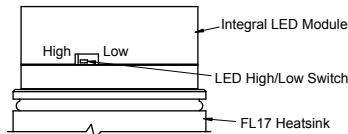

Accessory Maintenance:

1. Remove cap and accessories as explained in Lamp/LED Module Maintenance steps 1 thru 5. Note: The Lens Gasket holds the Lens and Accessories, acting as a lens seal and an accessory holder.
2. Remove Accessories from Lens Gasket, being careful not to damage Lens Gasket.
3. Clean and inspect Cap, Lens Gasket, and Accessories with a clean, damp cotton cloth. Replace damaged parts if necessary.
4. Carefully install new Accessories into Lens Gasket, being very careful to not damage it.
5. Install as explained in Lamp/LED Module Maintenance steps 7 thru 10.